

wall mounting appliance inlet - with closure cap



| Product description | |
|-------------------------------|----------------------------------|
| BALS-Prd.-Nr | 2485 |
| EAN | 4024941024853 |
| product category (PG) | GT wall mounting appliance inlet |
| current (A) | 16A |
| number of poles (P99) | 3p |
| number of poles (P) | 2P+PE |
| position of earth contact (H) | 6 h |
| voltage (V) | 200 up to 250V |
| frequency (HZ) | 50 and 60Hz |

| Product description | |
|-----------------------------|---|
| protection degree (SA) | IP67 |
| colour code 1 (KF1) | blue RAL 5015 |
| Colour of appliance | Closure cap grey, Collar blue, Bayonet ring grey, Housing bottom grey, Housing top grey |
| connection design (AT) | screw terminal |
| maximum conductor size (LQ) | 2,5 qmm |
| cable entry (KE) | top entry M20 |
| Height | 138mm |
| Width | 70mm |
| Depth | 112mm |
| dimension of enclosure (GG) | 87x64 mm (HxW) |
| material of enclosure (GM) | Polyamide |
| contact | The contact carrier is made of polyamide, the contacts are brass nickel plated |

| Additional technical information | |
|----------------------------------|---|
| | The cable entry is one at top open and one at bottom and one rear side closed |
| | With closure cap |

| Logistics data | |
|----------------|------------------|
| Weight/pcs | 0.241 kg / Piece |
| Packaging | Bag |
| Content amount | 1 ST |

| Logistics data | |
|----------------|---------------|
| EAN | 4024941024853 |
| Length | 112 mm |
| Width | 70 mm |
| Height | 138 mm |
| Weight | 0.242 kg |
| Volume | 1,081.92 ccm |
| Packaging | Carton |
| Content amount | 10 ST |
| EAN | 4024941968416 |
| Length | 325 mm |
| Width | 217 mm |
| Height | 210 mm |
| Weight | 2.616 kg |
| Volume | 13,588.4 ccm |

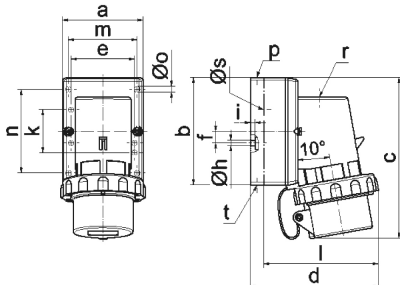

5 MB 127

| Ampere | 16 | 16 | 16 | 32 | 32 | 32 |
|---------|---------|---------|-------|-------|-------|-------|
| Polzahl | 3 | 4 | 5 | 3 | 4 | 5 |
| a | 64,0 | 75,0 | 84,0 | 90,0 | 90,0 | 90,0 |
| b | 87,0 | 100,0 | 84,0 | 75,0 | 75,0 | 75,0 |
| c | 137,0 | 151,0 | 137,0 | 147,0 | 147,0 | 148,0 |
| d | 112,0 | 119,0 | - | 122,0 | 122,0 | 123,0 |
| e | 51,0 | 59,0 | - | - | - | - |
| f | - | 11,0 | - | - | - | - |
| h ø | 4,1 | 5,1 | - | - | - | - |
| i | 4,5 | 4,5 | - | - | - | - |
| k | 40,0 | - | - | - | - | - |
| l | - | - | 111,0 | - | - | - |
| m | - | - | 64,0 | 78,0 | 78,0 | 78,0 |
| n | - | - | 64,0 | 45,0 | 45,0 | 45,0 |
| o ø | - | - | 5,5 | 5,5 | 5,5 | 5,5 |
| p | M20 | M20 | - | - | - | - |
| r | - | - | M20 | M25 | M25 | M25 |
| s ø | - | - | 23,0 | 29,0 | 29,0 | 29,0 |
| t | für M20 | für M20 | - | - | - | - |