

wall mounting appliance inlet - with external fixing



| Product description | |
|---------------------------|---|
| BALS-Prd.-Nr | 24392 |
| EAN | 4024941243926 |
| product group | wall mounting appliance inlet Quick-Connect |
| current | 16A |
| number of poles | 4p |
| Arrangement of the phases | 3P+PE |
| position of earth contact | 6 h |
| voltage (V) | 380 up to 415V |
| frequency | 50 and 60Hz |

| Product description | |
|-----------------------------|--|
| protection degree | IP44 |
| colour code | red RAL 3000 |
| Colour of appliance | Housing top red, Collar red, Housing bottom grey |
| connection design | screwless spring-clamp |
| maximum conductor size (LQ) | 2,5 qmm |
| cable entry (KE) | top entry M25 |
| Height | 120mm |
| Width | 87mm |
| Depth | 83mm |
| dimension of enclosure (GG) | 90x87 mm (HxW) |
| material of enclosure | Polyamide |
| contact | The contact carrier is made of polyamide, The contacts are brass |

| Additional technical information | |
|----------------------------------|---|
| | The cable entry is one at top open and one at bottom closed |

| Logistics data | |
|----------------|-----------------|
| Weight/pcs | 0.18 kg / Piece |
| Packaging | Bag |
| Content amount | 1 ST |
| EAN | 4024941243926 |

| Logistics data | |
|----------------|---------------|
| Length | 83 mm |
| Width | 87 mm |
| Height | 120 mm |
| Weight | 0.181 kg |
| Volume | 866.52 ccm |
| Packaging | Carton |
| Content amount | 10 ST |
| EAN | 4024941967549 |
| Length | 387 mm |
| Width | 222 mm |
| Height | 150 mm |
| Weight | 1.993 kg |
| Volume | 11,029.5 ccm |

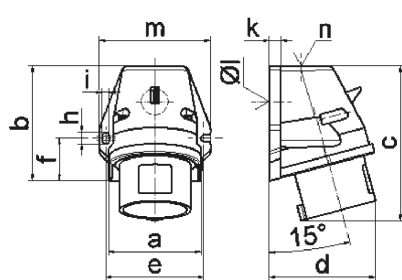

5 MB 44

| Ampere | 16 | 16 | 16 | 32 | 32 | 32 |
|----------------|-------|-------|-------|-------|-------|-------|
| Polzahl | 3 | 4 | 5 | 3 | 4 | 5 |
| a | 59,5 | 72,4 | 72,4 | 79,1 | 79,1 | 79,1 |
| b | 90,0 | 90,0 | 90,0 | 92,0 | 92,0 | 92,0 |
| c | 120,0 | 120,0 | 122,0 | 134,0 | 134,0 | 134,0 |
| d | 72,0 | 84,0 | 84,0 | 89,0 | 89,0 | 89,0 |
| e | 62,0 | 77,0 | 77,0 | 84,0 | 84,0 | 84,0 |
| f | 33,5 | 33,5 | 33,5 | 30,0 | 30,0 | 30,0 |
| h | 9,0 | 9,0 | 9,0 | 9,0 | 9,0 | 9,0 |
| i | 5,5 | 5,5 | 5,5 | 5,5 | 5,5 | 5,5 |
| k | 8,0 | 9,0 | 9,0 | 9,0 | 9,0 | 9,0 |
| l ø | 21,0 | 21,0 | 21,0 | 21,0 | 21,0 | 21,0 |
| m | 72,0 | 87,0 | 87,0 | 94,0 | 94,0 | 94,0 |
| n | M20 | M25 | M25 | M25 | M25 | M25 |
| Leiter mm² min | 1 | 1 | 1 | 2,5 | 2,5 | 2,5 |
| Leiter mm² max | 2,5 | 2,5 | 2,5 | 6 | 6 | 6 |