

## wall mounting socket outlet, fused - housing dimensions 260x160, with RCCB



Product description	
BALS-Prd.-Nr	15150
EAN	4024941151504
product category (PG)	GT wall mounting socket outlet, fused
current (A)	32A
number of poles (P99)	5p
number of poles (P)	3p+N+PE
position of earth contact (H)	6 h
voltage (V)	200/346 up to 240/415V

Product description	
frequency (HZ)	50 and 60Hz
protection degree (SA)	IP67
colour code 1 (KF1)	red RAL 3000
Colour of appliance	Operating window smoky topaz, Hinged lid red, Bayonet ring grey, Housing screws grey, Housing bottom grey, Housing top grey
connection design (AT)	screw terminal
maximum conductor size (LQ)	10,0 qmm
cable entry (KE)	top entry M40, bottom entry M40/M32
Height	296mm
Width	160mm
Depth	174mm
dimension of enclosure (GG)	260x160 mm (HxW)
material of enclosure (GM)	Polycarbonate
contact	The contact carrier is made of polyamide, the contacts are brass nickel plated

Additional technical information	
	The cable entry is one at top and two at bottom open
	With 4 pole 40/0.03A RCCB

Logistics data	
Weight/pcs	1.97 kg / Piece
Packaging	Carton

Logistics data	
Content amount	1 ST
EAN	4024941151504
Length	325 mm
Width	217 mm
Height	210 mm
Weight	2.186 kg
Volume	13,588.4 ccm

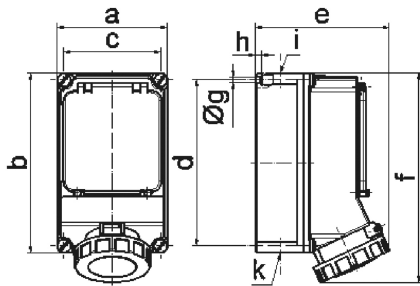

14 MB 11

Ampere Polzahl	32 4	32 5	63 4	63 5
a	160,0	160,0	160,0	160,0
b	260,0	260,0	260,0	260,0
c	140,0	140,0	140,0	140,0
d	240,0	240,0	240,0	240,0
e	172,0	174,0	195,0	195,0
f	293,0	294,0	304,0	304,0
g Ø	8,1	8,1	8,1	8,1
h	10,0	10,0	10,0	10,0
i	M40	M40	M40	M40
k	M32/40	M32/40	M32/40	M32/40