

## wall mounting socket outlet - housing dimensions 91x91



Product description	
BALS-Prd.-Nr	1184
EAN	4024941011846
product group	Wall mounting socket outlet
current	16A
number of poles	3p
Arrangement of the phases	2P+PE
position of earth contact	9 h
voltage (V)	380 up to 415V
frequency	50 and 60Hz

Product description	
protection degree	IP44
colour code	red RAL 3000
Colour of appliance	Hinged lid grey, Housing bottom grey, Enclosure grey
connection design	with screw terminal
maximum conductor size (LQ)	4,0 qmm
cable entry (KE)	Anti-kink sleeve
Height	100mm
Width	91mm
Depth	79.5mm
dimension of enclosure (GG)	91x91 mm
material of enclosure	Polyamide
contact	The contact carrier is made of polyamide, The contacts are brass

Additional technical information	
	The cable entry is one at top open and one at bottom and one rear side closed
	straight

Logistics data	
Weight/pcs	0.24 kg / Piece
Packaging	Carton
Content amount	10 ST

Logistics data	
EAN	4024941828642
Length	258 mm
Width	183 mm
Height	212 mm
Weight	2.549 kg
Volume	8,750 ccm

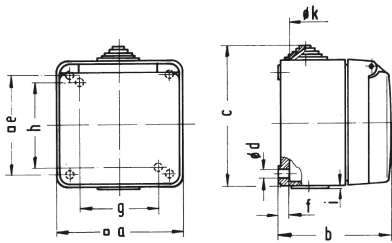

Ampere Polzahl	16 3	16 5	32 5				
a □	91,0	91,0	90,0				
b	79,5	79,5	93,0				
c	100,0	100,0	112,5				
d ø	5,5	5,5	5,5				
e □	73,0	73,0	-				
f	7,0	7,0	6,0				
g	-	-	58,0				
h ø	-	-	73,0				
i	-	-	1,5				
k ø	20,0 max.	20,0 max.	8,0/ 20,0				

4 MB 16