

wall mounting socket outlet - straight, housing dimensions 102x102 mm



Product description	
BALS-Prd.-Nr	110571
EAN	4024941938686
product group	TE wall mounting socket outlet Quick-Connect
current	32A
number of poles	4p
Arrangement of the phases	3P+PE
position of earth contact	9 h
voltage (V)	200 up to 250V

Product description	
frequency	50 and 60Hz
protection degree	IP67
colour code	blue RAL 5015
Colour of appliance	Hinged lid blue, Enclosure grey
connection design	screwless sping/cage/kontex
maximum conductor size (LQ)	10,0 qmm
cable entry (KE)	3 sides 2x M20/25, 1 side 1x M20/25, to break out
Height	102mm
Width	102mm
Depth	134mm
dimension of enclosure (GG)	102x102 mm (HxW)
material of enclosure	Copolymer/Polyamide
contact	The contact carrier is made of high temperature resistant material, the contacts are brass nickel plated

Additional technical information	
	All cable entries are to break out

Logistics data	
Weight/pcs	0.435 kg / Piece
Packaging	Bag
Content amount	1 ST

Logistics data	
EAN	4024941938686
Length	134 mm
Width	102 mm
Height	102 mm
Weight	0.436 kg
Volume	1,394.136 ccm
Packaging	Carton
Content amount	10 ST
EAN	4024941827522
Length	330 mm
Width	216 mm
Height	260 mm
Weight	4.576 kg
Volume	17,062.5 ccm

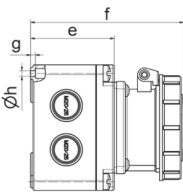
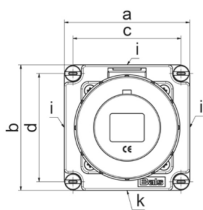

Ampere Polzahl	16 3	16 4	16 5	32 3	32 4	32 5
a	102,0	102,0	102,0	102,0	102,0	102,0
b	102,0	102,0	102,0	102,0	102,0	102,0
c	88,0	88,0	88,0	88,0	88,0	88,0
d	88,0	88,0	88,0	88,0	88,0	88,0
e	68,0	68,0	68,0	68,0	68,0	68,0
f	124,0	125,0	124,0	134,0	134,0	134,0
g	4,0	4,0	4,0	4,0	4,0	4,0
h ø	4,5	4,5	4,5	4,5	4,5	4,5
i	2xM20/25	2xM20/25	2xM20/25	2xM20/25	2xM20/25	2xM20/25
k	M20/25	M20/25	M20/25	M20/25	M20/25	M20/25
Leiter mm ² min	1,5	1,5	1,5	2,5	2,5	2,5
Leiter mm ² max	4	4	4	10	10	10

1 MB 121