

wall mounting socket outlet - straight, housing dimensions 102x102 mm



Product description	
BALS-Prd.-Nr	110565
EAN	4024941938624
product group	TE wall mounting socket outlet Quick-Connect
current	16A
number of poles	5p
Arrangement of the phases	3p+N+PE
position of earth contact	6 h
voltage (V)	200/346 up to 240/415V

Product description	
frequency	50 and 60Hz
protection degree	IP67
colour code	red RAL 3000
Colour of appliance	Hinged lid red, Enclosure grey
connection design	screwless sping/cage/kontex
maximum conductor size (LQ)	4,0 qmm
cable entry (KE)	3 sides 2x M20/25, 1 side 1x M20/25, to break out
Height	102mm
Width	102mm
Depth	125mm
dimension of enclosure (GG)	102x102 mm (HxW)
material of enclosure	Copolymer/Polyamide
contact	The contact carrier is made of high temperature resistant material, the contacts are brass nickel plated

Additional technical information	
	All cable entries are to break out

Logistics data	
Weight/pcs	0.375 kg / Piece
Packaging	Bag
Content amount	1 ST

Logistics data	
EAN	4024941938624
Length	125 mm
Width	102 mm
Height	102 mm
Weight	0.376 kg
Volume	1,300.5 ccm
Packaging	Carton
Content amount	10 ST
EAN	4024941828482
Length	325 mm
Width	217 mm
Height	210 mm
Weight	3.956 kg
Volume	13,588.4 ccm

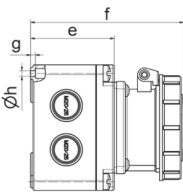
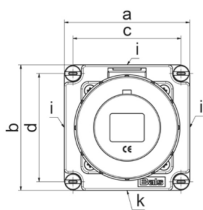

Ampere Polzahl	16 3	16 4	16 5	32 3	32 4	32 5
a	102,0	102,0	102,0	102,0	102,0	102,0
b	102,0	102,0	102,0	102,0	102,0	102,0
c	88,0	88,0	88,0	88,0	88,0	88,0
d	88,0	88,0	88,0	88,0	88,0	88,0
e	68,0	68,0	68,0	68,0	68,0	68,0
f	124,0	125,0	124,0	134,0	134,0	134,0
g	4,0	4,0	4,0	4,0	4,0	4,0
h ø	4,5	4,5	4,5	4,5	4,5	4,5
i	2xM20/25	2xM20/25	2xM20/25	2xM20/25	2xM20/25	2xM20/25
k	M20/25	M20/25	M20/25	M20/25	M20/25	M20/25
Leiter mm ² min	1,5	1,5	1,5	2,5	2,5	2,5
Leiter mm ² max	4	4	4	10	10	10

1 MB 121