

wall mounting socket outlet - straight, housing dimensions 102x102 mm



Product description	
BALS-Prd.-Nr	110559
EAN	4024941938563
product group	TE wall mounting socket outlet Quick-Connect
current	16A
number of poles	3p
Arrangement of the phases	2P+PE
position of earth contact	6 h
voltage (V)	200 up to 250V

Product description	
frequency	50 and 60Hz
protection degree	IP67
colour code	blue RAL 5015
Colour of appliance	Hinged lid blue, Enclosure grey
connection design	screwless sping/cage/kontex
maximum conductor size (LQ)	4,0 qmm
cable entry (KE)	3 sides 2x M20/25, 1 side 1x M20/25, to break out
Height	102mm
Width	102mm
Depth	125mm
dimension of enclosure (GG)	102x102 mm (HxW)
material of enclosure	Copolymer/Polyamide
contact	The contact carrier is made of high temperature resistant material, the contacts are brass nickel plated

Additional technical information	
	All cable entries are to break out

Logistics data	
Weight/pcs	0.34 kg / Piece
Packaging	Bag
Content amount	1 ST

Logistics data	
EAN	4024941938563
Length	125 mm
Width	102 mm
Height	102 mm
Weight	0.341 kg
Volume	1,300.5 ccm
Packaging	Carton
Content amount	10 ST
EAN	4024941827485
Length	325 mm
Width	217 mm
Height	210 mm
Weight	3.606 kg
Volume	13,588.4 ccm

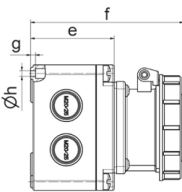
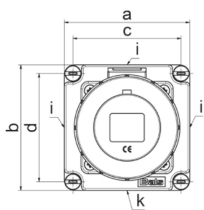

Ampere Polzahl	16 3	16 4	16 5	32 3	32 4	32 5
a	102,0	102,0	102,0	102,0	102,0	102,0
b	102,0	102,0	102,0	102,0	102,0	102,0
c	88,0	88,0	88,0	88,0	88,0	88,0
d	88,0	88,0	88,0	88,0	88,0	88,0
e	68,0	68,0	68,0	68,0	68,0	68,0
f	124,0	125,0	124,0	134,0	134,0	134,0
g	4,0	4,0	4,0	4,0	4,0	4,0
h ø	4,5	4,5	4,5	4,5	4,5	4,5
i	2xM20/25	2xM20/25	2xM20/25	2xM20/25	2xM20/25	2xM20/25
k	M20/25	M20/25	M20/25	M20/25	M20/25	M20/25
Leiter mm ² min	1,5	1,5	1,5	2,5	2,5	2,5
Leiter mm ² max	4	4	4	10	10	10

1 MB 121